

## MK-401/402 replacement for ATA TX-4A remote

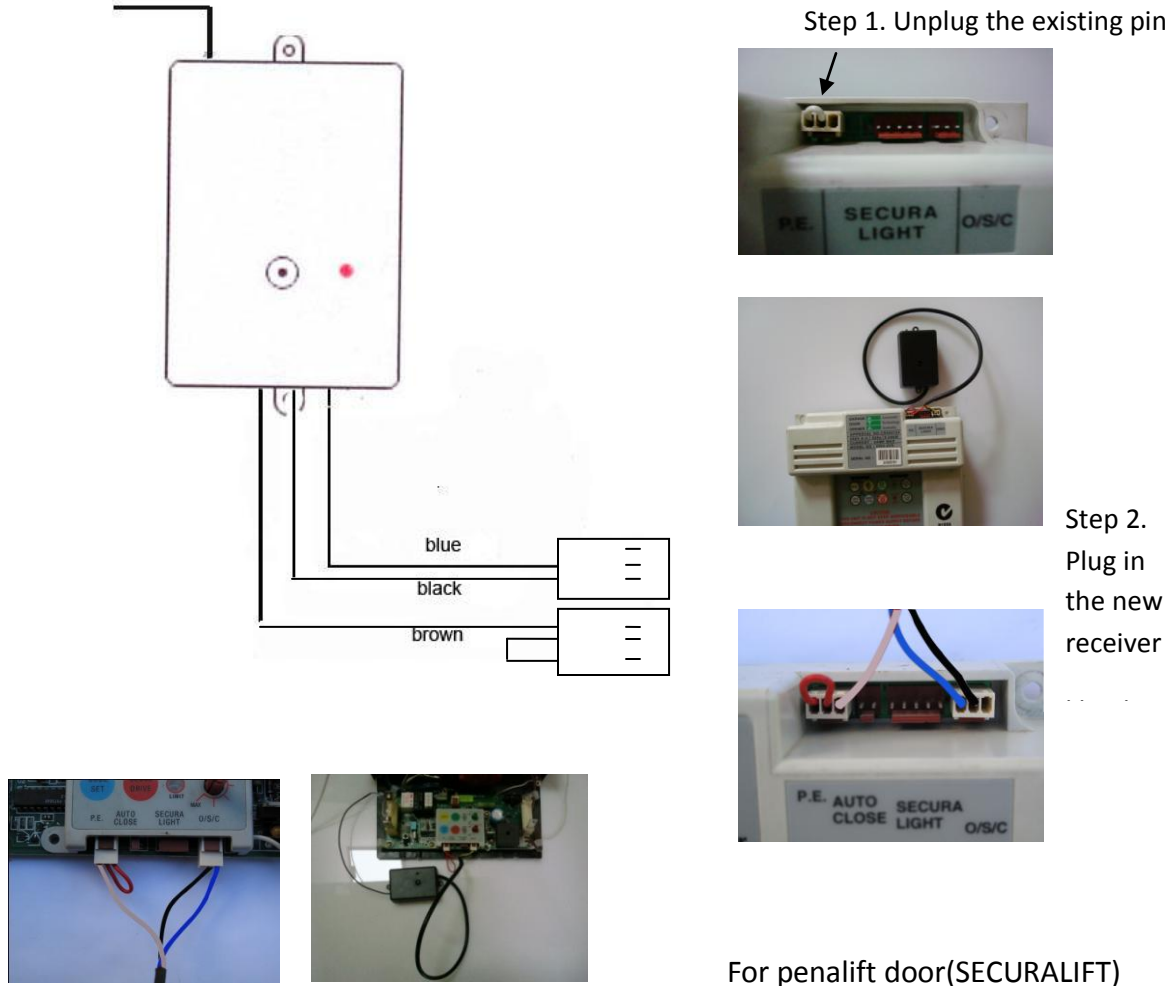

The illustration above shows the connection of the receiver. There are 2 connectors which are needed to be plugged into the back of the power head. (different way shown for the different type of door). Your original remotes will still work well.

The control board can be seen after the cover is taken off.

The remote of the conversion kit has been programmed for you already. The programming instruction is as follows:

1. Press LEARN button, which is on the Receiver once, the Signal LED will flash
2. Press one button of the transmitter, Signal LED will be steady.
3. Press the same button of the remote again, LED will flash
4. When the LED stops flashing, the coding sequence is complete.

Delete coding

Press and hold LEARN button until the light is on, all the coding are deleted.